

# Motorized Cellular Shade Instructions

## Contents

- 1-1. Set or Modify Upper Limit
- 1-2. Set or Modify Lower Limit
- 2-1. Add Remote Control
- 3-1. Change Curtain Direction
- 4-1. Clear Pairing Code
- 5-1. Connect External Manual Switch
- 6-1. How to Replace the Battery
- 6-2. Product Specifications
- 6-3. Quick Setup Guide
- 6-4. Remote Holder Instructions

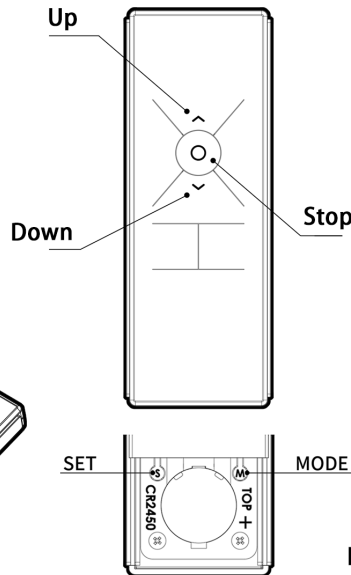
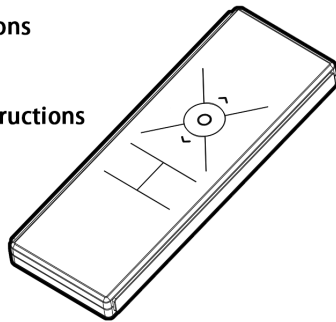

## How to Open the Battery Cover

⚠ Slide the cover out.

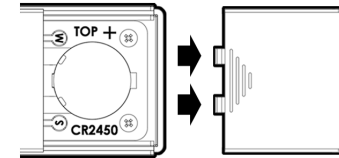

## How to Reattach the Battery Cover

- 1 Insert the latch into the slot.
- 2 Align the cover with the track.
- 3 Slide it back into place.

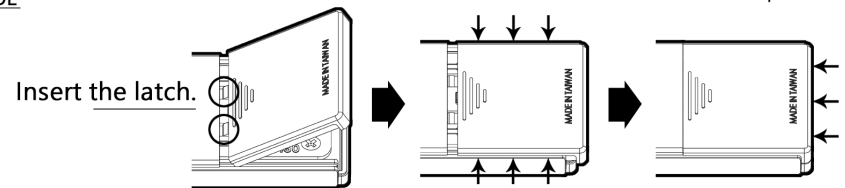

## Pre-Setup Checklist:

- 1 Always set the upper limit before setting the lower limit.
- 2 Ensure the shade moves in the correct direction—pressing “Up” should raise the shade, and “Down” should lower it. If the directions are reversed, refer to section 3-1 to adjust the motor direction.

## 1-1 Set or Modify Upper Limit

**STEP-1** Press **SET + UP**. Three short beeps indicate entry into upper limit setting mode.

**STEP-2** Press **UP** or **DOWN** to move the cellular shade to the desired upper limit position.

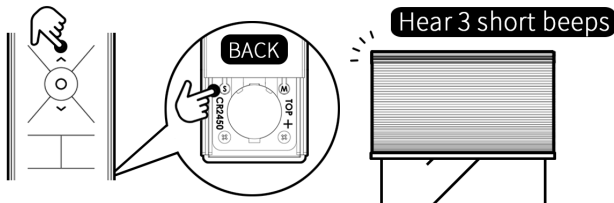

Tap to fine-tune  
Hold 2 sec  
for continuous move

Note

To prevent damage, press **STOP** before reaching the upper limit, then fine-tune to the exact position.

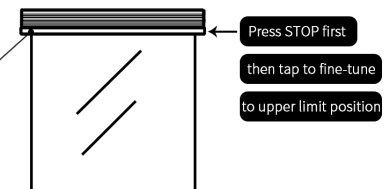

# Motorized Cellular Shade Instructions

## STEP-3

When the desired position is reached, press **STOP**, then press **SET+ Left or Right** to confirm. A long beep indicates the setting is complete.

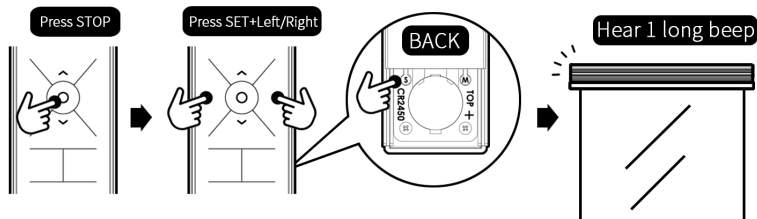

Setting complete

After completion, the upper limit mode exits, and all lower limits are cleared.

## 1-2 Set or Modify Lower Limit

### STEP-1

Press **SET + DOWN**. Three short beeps indicate entry into lower limit setting mode.

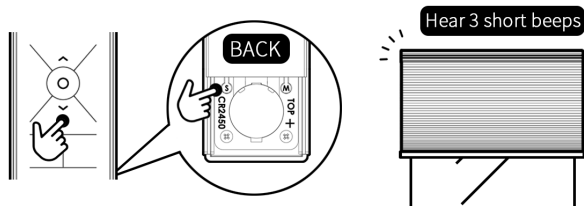

### STEP-2

Press **UP** or **DOWN** to move the cellular shade to the desired lower limit position.

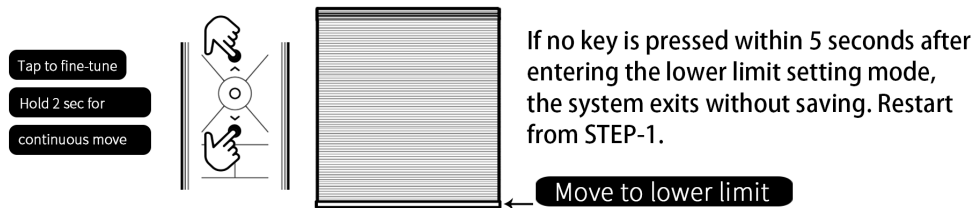

### STEP-3

When the desired position is reached, press **STOP**, then press **SET+Left or Right** to confirm. A long beep indicates the setting is complete.

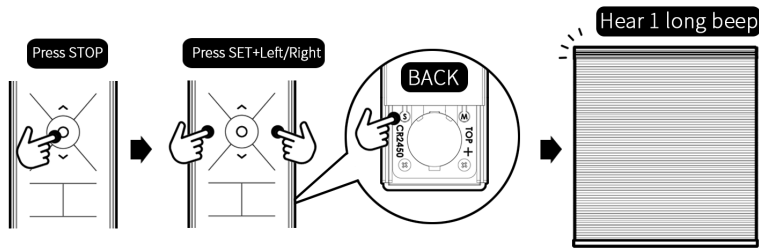

Setting complete

After setting, the system exits lower limit mode.

# Motorized Cellular Shade Instructions

## 2-1 Add Remote Control

**STEP-1** Hold **SET** until 3 short beeps sound — enter setup mode.

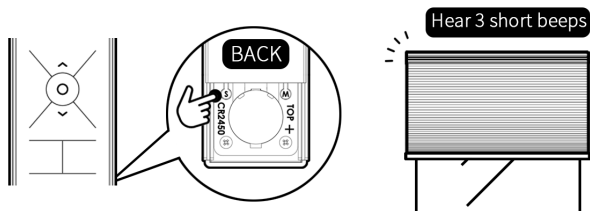

**STEP-2** Press **STOP** on the new remote.  
A long beep confirms pairing is complete.

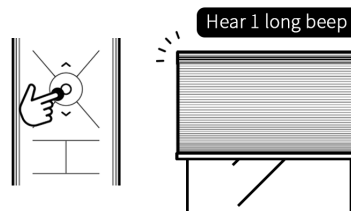

Pairing complete

After pairing, don't press any key.  
Wait 5 seconds, motor vibrates  
and exits setup mode.

## 3-1 Change Curtain Direction

**STEP-1** Hold **SET** until 3 short beeps sound — enter setup mode.

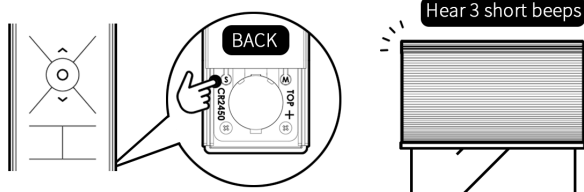

**STEP-2** Press **UP + DOWN**.  
After motor beeps, press remote **UP** and **DOWN** to check direction.  
If reversed, press **UP + DOWN** again to correct.

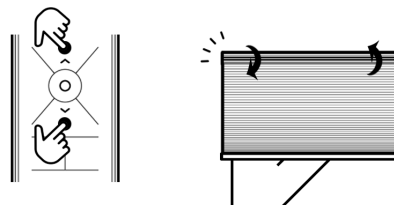

Setting complete

After setup, don't press any key.  
Wait 5 seconds, motor exits setup mode.

# Motorized Cellular Shade Instructions

## 4-1 Clear Pairing Code

**STEP-1** Unplug the motor. Wait 15 seconds, then plug it back in. Within 8 seconds, press **UP + STOP + DOWN + Left/Right** together. The buzzer will start beeping. Within 5 seconds, press **UP + DOWN** together. One long beep then stops—clearing complete.

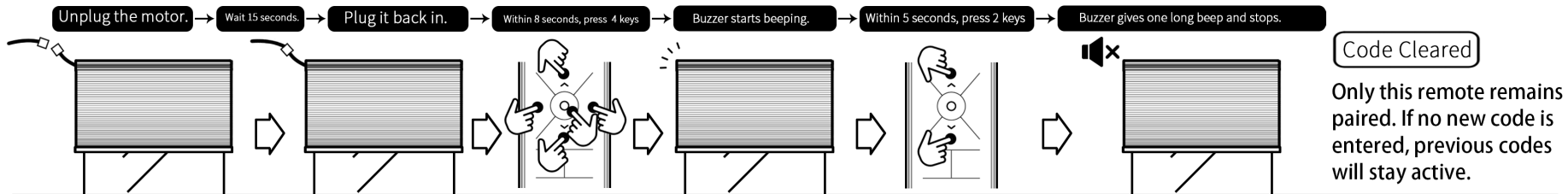

## 5-1 Connect External Manual Switch

Follow same steps as remote control setup (see 1-1 to 1-3).

System control terminal    Manual switch wire

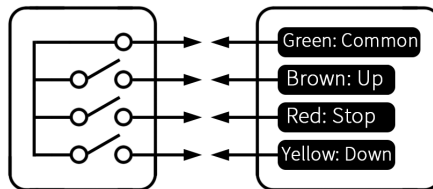
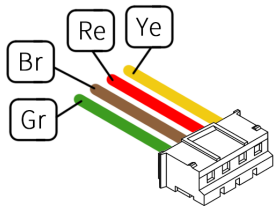

Tap briefly to operate.  
Do not short-circuit continuously.

## 6-1 How to Replace the Battery

- 1 Face the smooth side (+) up. Align both ends with the clips and insert at an angle.
- 2 Done.

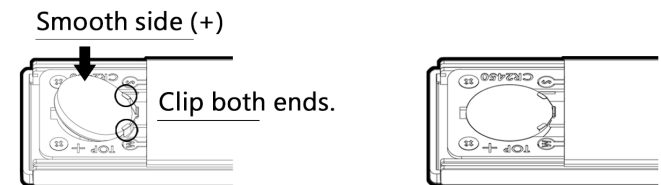

# Motorized Cellular Shade Instructions

## 6-2 Specifications

Battery: CR2450 3V (non-rechargeable lithium)  
Size: L13cm × W4.8cm × H1.1cm  
Standby Current: <1uA  
Modulation: OOK  
Encoding: Fixed internal code  
Frequency: 433.92MHz  
Antenna: On-board, Gain = 0 dBi  
Weight (with battery): 66g

## 6-3 Quick Setup Guide

Set upper limit: SET + UP → Adjust → STOP → Confirm with SET+Left/Right  
Set lower limit: SET + DOWN → Adjust → STOP → Confirm with SET+Left/Right  
Add remote: SET → (Remote 2) STOP  
Change direction: SET → UP + DOWN (to toggle direction)  
Clear code: UP + STOP + DOWN + Left/Right → UP + DOWN

## 6-4 Remote Holder Instructions

### Stand

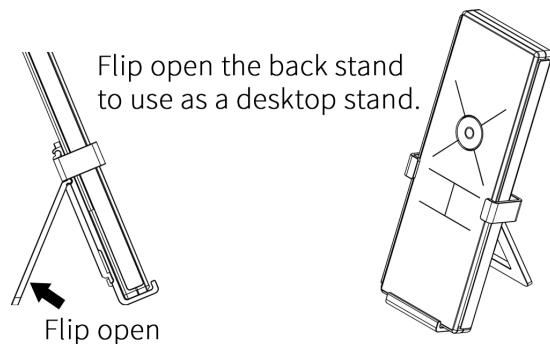

### Wall Mount

Stick the included double-sided tape on the back, then attach to the desired wall location.

Apply tape here

